

The logo for Med Systems, featuring the words "MED SYSTEMS" in a bold, sans-serif font inside a rectangular box. Above the box is a semi-circle, and below it is another semi-circle, with a registered trademark symbol (®) positioned between the two semi-circles.

## 2500 Series Service - Rework Instructions

2631 Ariane Dr., San Diego, CA 92117

(800) 345-9061 [www.Medsystems.com](http://www.Medsystems.com)

This rework procedure applies to the **2500, 2700 and 2900** percussors. Refer to the drawing and parts list on page 2 of this document to identify the part numbers and their locations on the percussor.

**CAUTIONS:** Oxygen hazard – **do not use petroleum-based lubricants**. Do not autoclave. Do not use acetone to clean the unit. **Clean** with hospital grade disinfecting wipes.

### REAR COVER REMOVAL:

- 1) Remove the two Phillips head screws (2534) from the rear cover. (See drawing on page 2).
- 2) Remove the Rear Cover (2519).
- 3) Take the Rear Pad (2527) out of the Rear Cover (2519) and save for re-installation.
- 4) Remove the Relief Spring (2537).
- 5) Use a flat head screwdriver to pull out the Rear Spirolox retaining clip (2539).
- 6) Take out the Ring (2518) and save for re-installation..
- 7) Take the Poppet Plate (2517) with Rear Diaphragm (2530) out to expose the center screw.

### TO DISASSEMBLE THE BODY:

- 8) Remove the center screw (2533) by first removing the Front Cap (2542) with a flat head screwdriver. (See drawing on page 2).
- 9) Hold the Nut (2532) with a ½ inch socket wrench while turning center screw counter clockwise.
- 10) Pull the Body (2511) from the Front cover (2512).
- 11) The center parts in the body can be removed by pulling out the Front Spirolox (2538) with a flat head screwdriver and then the Spacer Guide (2514) by placing a screwdriver in the center hole and tilting back and forth until it unseals itself from the Front Diaphragm (2529).
- 12) Remove both of the Internal (2561) and External Springs (2562), Hammer (2515) with Pad (2525), Front Diaphragm (2529) and Fender Washer (2522).
- 13) Remove Knob (2521) from Body (2511) and inspect the opening under it, clean if necessary.
- 14) While holding the Nut (2532) with a socket wrench, unscrew the Shaft (2516) from the Front Cover (2512) and replace Front Cover with a new one.

### REASSEMBLY PROCEDURE:

- 15) Clean the rest of the parts with alcohol. For best results lube the Spacer Guide where it contacts the Diaphragm and the knob threads and its O-ring with synthetic grease. Caution: Oxygen Hazard – **Do not use petroleum based lubricants. ONLY USE Super Lube® Synthetic Grease (Item No. 21030).**
- 16) Discard the following as these will be in the Tune-up Kit: Screws, Relief Spring, Front and Rear Covers, Spacer Guide, Front and Rear Diaphragms, Rear Discs, Front Cap and Poppet Plate.
- 17) Body parts installation; start with the Washer (2522) then install the Front Diaphragm (2529), Hammer (2515) with Pad (2525), Internal (2561) and External Springs (2562), Spacer Guide (2514) and lock in place with Front Spirolox (2538).
- 18) Place Body (2511) over Front Cover assembly with Screw (2533). Install Knob (2521).
- 19) Install Poppet Plate (2517) with Rear Diaphragm (2530), Ring (2518) and lock in place with Rear Spirolox (2539).
- 20) Snap the Relief Spring (2537) in center of poppet plate (2517).
- 21) Install Rear Foam Disc (2526) and new Rear Pad (2527) in Rear Cover (2519).
- 22) Place the Rear Cover (2519) with Rear Cover Screws (2534), and finally install Front Cap (2542).

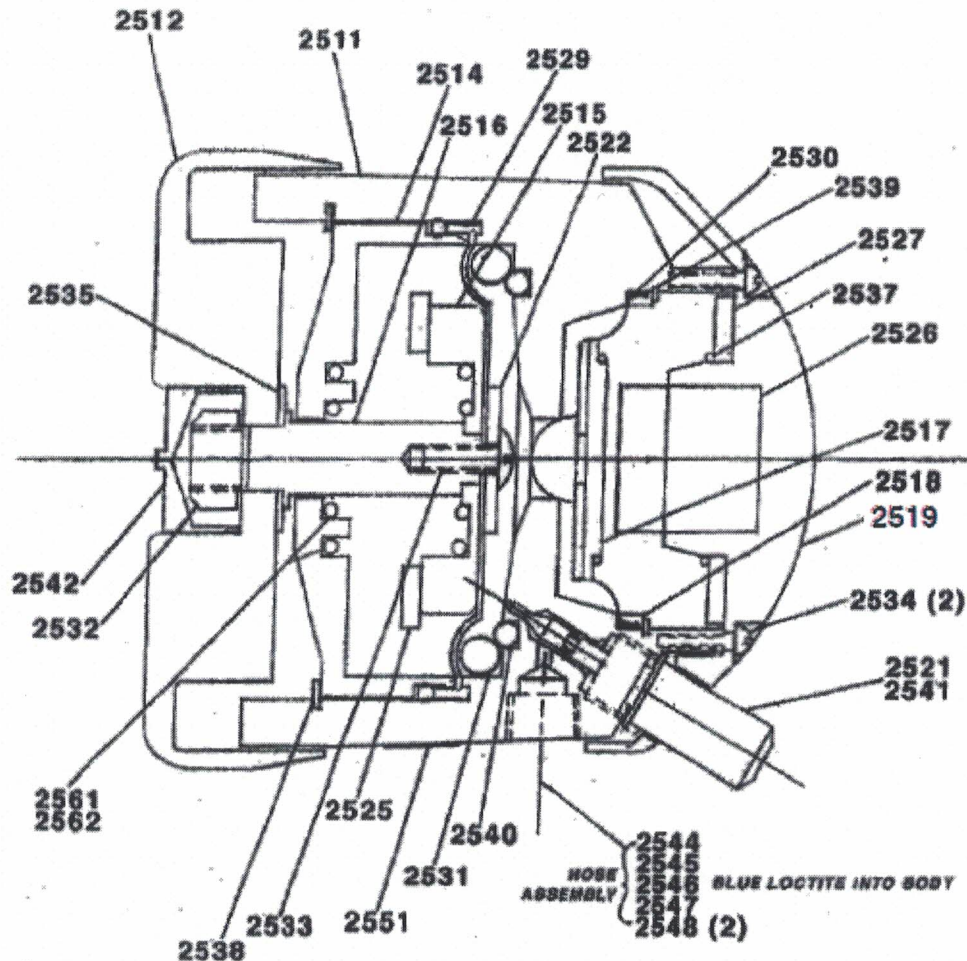

PART #	DESCRIPTION
2506	Factory tune-up Kit w/ 1 year warranty
2510	Tune-up Kit (includes * parts)
2511	Percussor Body
2512*	Front Cover
2514*	Spacer Guide
2515	Hammer
2516	Shaft
2517*	Poppet Plate
2518	Ring
2519*	Rear Cover
2521	Knob
2522	Washer
2525	Hammer Pad
2526*	Rear Foam Disc
2527	Rear Pad
2529*	Front Diaphragm (2.5 ")
2530*	Rear Diaphragm (1.5 ")
21030	Super Lube Synthetic Grease

PART #	DESCRIPTION
2531	O-ring
2532	Nut
2533*	Screw
2534*	Rear Cover Screws (2)
2535	Washer
2537*	Relief Spring
2538	Front Spirolox
2539	Rear Spirolox
2540	Impact O-ring
2541	Knob O-ring
2542*	Front Cap
2544	DISS Oxygen 10' Hose Assembly
2545	Barb 1/8 NPT
2547	Nut 9/16-18
2548	Ferrule
2561	Internal Spring
2562	External Spring